

ROAD ALLOWANCE.

L.S. 14 Sec. 30-1-4-2. L.S. 14 Sec. 30-1-4-2.

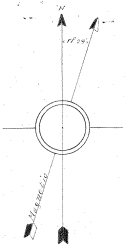

STATION	DIST.	REMARKS
1-0	1000	Div. 30-1-4-2 L.S. 14 Sec. 30-1-4-2
2-0	700	250' MIN. DIST. FROM ROAD
3-0	500	250' MIN. DIST. FROM ROAD
4-0	300	250' MIN. DIST. FROM ROAD
5-0	100	250' MIN. DIST. FROM ROAD
6-0	0	250' MIN. DIST. FROM ROAD
7-0	0	250' MIN. DIST. FROM ROAD
8-0	0	250' MIN. DIST. FROM ROAD
9-0	0	250' MIN. DIST. FROM ROAD
10-0	0	250' MIN. DIST. FROM ROAD
11-0	0	250' MIN. DIST. FROM ROAD
12-0	0	250' MIN. DIST. FROM ROAD
13-0	0	250' MIN. DIST. FROM ROAD
14-0	0	250' MIN. DIST. FROM ROAD
15-0	0	250' MIN. DIST. FROM ROAD
16-0	0	250' MIN. DIST. FROM ROAD
17-0	0	250' MIN. DIST. FROM ROAD
18-0	0	250' MIN. DIST. FROM ROAD
19-0	0	250' MIN. DIST. FROM ROAD
20-0	0	250' MIN. DIST. FROM ROAD
21-0	0	250' MIN. DIST. FROM ROAD
22-0	0	250' MIN. DIST. FROM ROAD

C. P. R. Coal Mining Leases Nos. 207 and 208 on 20 of Sections 30-1-4-2 L.S. 14 and N.W. 1/4 of Section 30-1-4-2 Mine operated by the Light Coal Mines Limited. Surveyed June 18<sup>th</sup> 1920. Scale 1 inch = 200 feet.

Robt. Co. R. P. E.

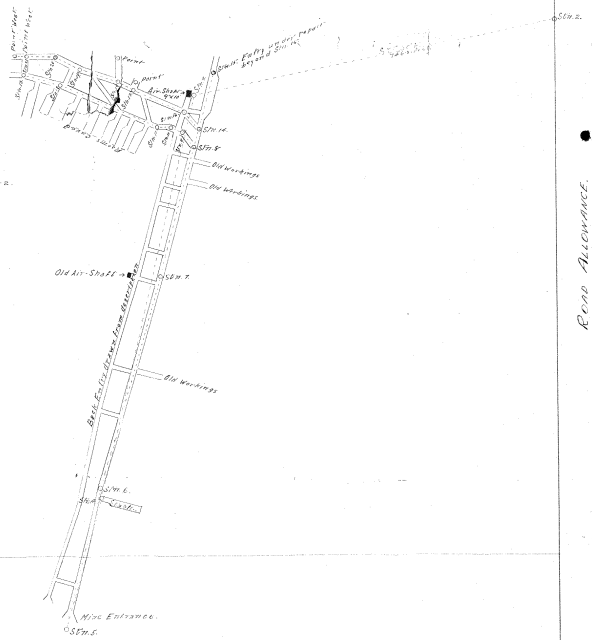
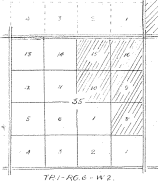
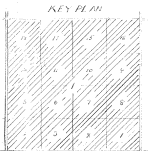
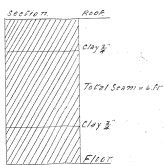

L.S. 14 Sec. 30-1-4-2. L.S. 14 Sec. 30-1-4-2.

L.S. 14 Sec. 30-1-4-2.

ROAD ALLOWANCE.